

StatSpin[®] Express 2 Tube Insert Guide

SV01¹
13 x 75mm

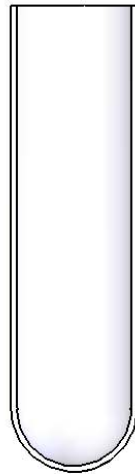

SV02
10.25 x 64mm



SV05²
1.5-2mL microtubes,
10.25 x 47mm, and
BD Microtainers[®]

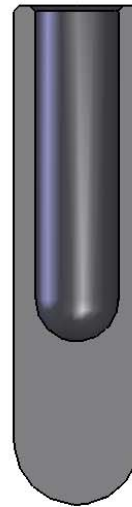

1. SV01 tube inserts included with Express 2
2. SV05 tube inserts replace SV03 and SV04 tube inserts